

EN 1092-1 NORMUNDA FLANŞ PN10

EN 1092-1 Flange PN10

Tip 1 DÜZ FLANŞ
Type 1 Slip-on Flange

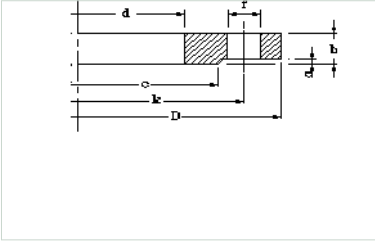

Tip 11 KAYNAK BOYUNLU FLANŞ
Type 11 Welding-Neck Flange

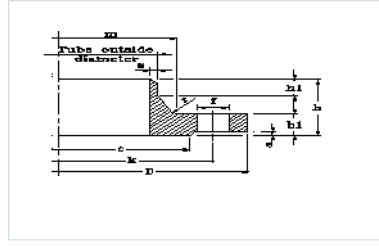

Tip 5 KÖR FLANŞ
Type 5 Blind Flange

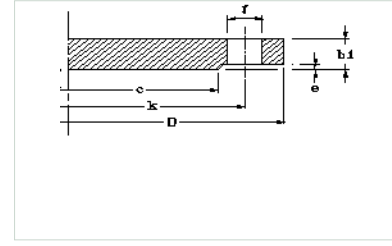

Tip 2 SERBEST FLANŞ
Type 2 Loose Flange

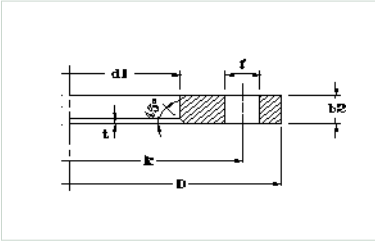

Tip 32 RİNG
Type 32 Collar

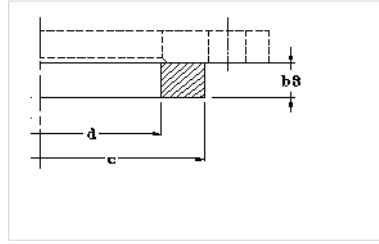

Tip 13 DIŞLİ FLANŞ
Type 13 Screwed Flange

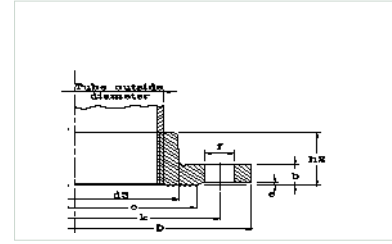

| Pipe Connection Dimensions | | | DIMENSIONS | | | | | | | | | | | | | | | | | BOLT | | | | |
|----------------------------|-----------------------|--------|------------|------|------|-----|----|----|----|----|-------|------|-----|-----|---|----|----|------|----|------|----|----|------|--|
| Nominal Diameter | Tube Outside Diameter | | D | k | c | h | b | b1 | b2 | b3 | d | d1 | d2 | s | e | h1 | h2 | m | r | t | f | No | Bolt | |
| DIN | ANSI | | | | | | | | | | | | | | | | | | | | | | | |
| DN 10 | 3/8" | 17.2 | 90 | 60 | 40 | 35 | 14 | 16 | 14 | 10 | 17.7 | 19 | 30 | 1.8 | 2 | 6 | 20 | 28 | 4 | 3 | 14 | 4 | M12 | |
| DN 15 | 1/2" | 21.3 | 95 | 65 | 45 | 35 | 14 | 16 | 14 | 10 | 22.0 | 24 | 35 | 2 | 2 | 6 | 20 | 32 | 4 | 3 | 14 | 4 | M12 | |
| DN 20 | 3/4" | 26.9 | 105 | 75 | 58 | 38 | 16 | 18 | 16 | 12 | 27.6 | 30 | 45 | 2.3 | 2 | 6 | 24 | 40 | 4 | 3 | 14 | 4 | M12 | |
| DN 25 | 1" | 33.7 | 115 | 85 | 68 | 38 | 16 | 18 | 16 | 12 | 34.4 | 36 | 52 | 2.6 | 2 | 6 | 24 | 45 | 4 | 4 | 14 | 4 | M12 | |
| DN 32 | 1 1/4" | 42.4 | 140 | 100 | 78 | 40 | 18 | 18 | 18 | 12 | 43.1 | 46 | 60 | 2.6 | 2 | 6 | 26 | 56 | 6 | 4 | 18 | 4 | M16 | |
| DN 40 | 1 1/2" | 48.3 | 150 | 110 | 88 | 42 | 18 | 18 | 18 | 12 | 49.0 | 54 | 70 | 2.6 | 3 | 7 | 26 | 64 | 6 | 4 | 18 | 4 | M16 | |
| DN 50 | 2" | 60.3 | 165 | 125 | 102 | 45 | 19 | 18 | 19 | 14 | 61.1 | 65 | 85 | 2.9 | 3 | 8 | 28 | 75 | 6 | 5 | 18 | 4 | M16 | |
| DN 65 | 2 1/2" | 76.1 | 185 | 145 | 122 | 45 | 20 | 18 | 20 | 14 | 77.1 | 81 | 105 | 2.9 | 3 | 10 | 32 | 90 | 6 | 5 | 18 | 4 | M16 | |
| DN 80 | 3" | 88.9 | 200 | 160 | 138 | 50 | 20 | 20 | 20 | 16 | 90.3 | 94 | 118 | 3.2 | 3 | 10 | 34 | 105 | 8 | 5 | 18 | 8 | M16 | |
| DN100 | 4" | 114.3 | 220 | 180 | 158 | 52 | 22 | 20 | 22 | 16 | 115.9 | 119 | 140 | 3.6 | 3 | 12 | 38 | 131 | 8 | 5 | 18 | 8 | M16 | |
| DN125 | 5" | 139.7 | 250 | 210 | 188 | 55 | 22 | 22 | 22 | 18 | 141.6 | 145 | | 4 | 3 | 12 | | 156 | 8 | 5 | 18 | 8 | M16 | |
| DN150 | 6" | 168.3 | 285 | 240 | 212 | 55 | 24 | 22 | 24 | 18 | 170.5 | 173 | | 4.5 | 3 | 12 | | 184 | 10 | 5 | 22 | 8 | M20 | |
| DN 200 | 8" | 219.1 | 340 | 295 | 268 | 62 | 24 | 24 | 24 | 20 | 221.8 | 225 | | 5.9 | 3 | 16 | | 235 | 10 | 5 | 22 | 8 | M20 | |
| DN 250 | 10" | 273 | 395 | 350 | 320 | 68 | 26 | 26 | 26 | 22 | 276.2 | 279 | | 6.3 | 3 | 16 | | 292 | 12 | 5 | 22 | 12 | M20 | |
| DN 300 | 12" | 323.9 | 445 | 400 | 370 | 68 | 26 | 26 | 26 | 22 | 327.6 | 329 | | 7.1 | 4 | 16 | | 344 | 12 | 5 | 22 | 12 | M20 | |
| DN 350 | 14" | 355.6 | 505 | 460 | 430 | 68 | 28 | 26 | 28 | 22 | 359.7 | 362 | | 7.1 | 4 | 16 | | 385 | 12 | 6 | 22 | 16 | M20 | |
| DN 400 | 16" | 406.4 | 565 | 515 | 482 | 72 | 32 | 26 | 32 | 24 | 411.0 | 413 | | 7.1 | 4 | 16 | | 440 | 12 | 6 | 26 | 16 | M24 | |
| DN 450 | 18" | 457 | 615 | 565 | 532 | 72 | 36 | 28 | 36 | 24 | 460.2 | 464 | | 7.1 | 4 | 16 | | 478 | 12 | 6 | 26 | 20 | M24 | |
| DN 500 | 20" | 508 | 670 | 620 | 585 | 75 | 38 | 28 | 38 | 26 | 511.0 | 517 | | 7.1 | 4 | 16 | | 542 | 12 | 6 | 26 | 20 | M24 | |
| DN 600 | 24" | 609.6 | 780 | 725 | 685 | 80 | 42 | 34 | 42 | 26 | 612.6 | 618 | | 7.1 | 5 | 18 | | 642 | 12 | 7 | 30 | 20 | M27 | |
| DN 700 | 28" | 711.2 | 895 | 840 | 800 | 80 | | | | 28 | 714.2 | 721 | | 8 | 5 | 18 | | 745 | 12 | 7 | 30 | 24 | M27 | |
| DN 800 | 32" | 812.8 | 1015 | 950 | 905 | 90 | | | | 30 | 815.8 | 824 | | 8 | 5 | 18 | | 850 | 12 | 7 | 33 | 24 | M30 | |
| DN 900 | 36" | 914.4 | 1115 | 1050 | 1005 | 95 | | | | 32 | 917.4 | 927 | | 10 | 5 | 20 | | 950 | 12 | 7 | 33 | 28 | M30 | |
| DN1000 | 40" | 1016 | 1230 | 1160 | 1110 | 95 | | | | 32 | 1020 | 1031 | | 10 | 5 | 20 | | 1052 | 16 | 8 | 36 | 28 | M33 | |
| DN1200 | 48" | 1219.2 | 1455 | 1380 | 1330 | 115 | | | | 32 | 1224 | 1236 | | 11 | 5 | 25 | | 1255 | 16 | 8 | 39 | 32 | M36 | |
| DN1400 | 56" | 1420 | 1675 | 1590 | 1535 | 120 | | | | | | | | 12 | 5 | 25 | | 1460 | 16 | | 42 | 36 | M39 | |
| DN1600 | 64" | 1620 | 1915 | 1820 | 1760 | 130 | | | | | | | | 14 | 5 | 25 | | 1665 | 16 | | 48 | 40 | M45 | |
| DN1800 | 72" | 1820 | 2115 | 2020 | 1960 | 140 | | | | | | | | 15 | 5 | 30 | | 1868 | 16 | | 48 | 44 | M45 | |
| DN 2000 | 80" | 2020 | 2325 | 2230 | 2170 | 150 | | | | | | | | 16 | 5 | 30 | | 2072 | 16 | | 48 | 48 | M45 | |
| DN 2200 | 88" | 2220 | 2550 | 2440 | 2370 | 160 | | | | | | | | 18 | 6 | 35 | | 2275 | 18 | | 56 | 52 | M52 | |
| DN 2400 | 96" | 2420 | 2760 | 2650 | 2570 | 170 | | | | | | | | 20 | 6 | 35 | | 2478 | 18 | | 56 | 56 | M52 | |
| DN 2600 | 104" | 2620 | 2960 | 2850 | 2780 | 180 | | | | | | | | 22 | 6 | 40 | | 2680 | 18 | | 56 | 60 | M52 | |
| DN 2800 | 112" | 2820 | 3180 | 3070 | 3000 | 190 | | | | | | | | 22 | 6 | 40 | | 2882 | 18 | | 56 | 64 | M52 | |
| DN 3000 | 120" | 3020 | 3405 | 3290 | 3210 | 200 | | | | | | | | 24 | 6 | 45 | | 3085 | 18 | | 62 | 68 | M56 | |

S BORU ET KALINLIĞI MİNİMUM ÖLÇÜDÜR. STOK ÜRÜNLERDE ET KALINLIĞI SCH 40 A UYGUNDUR